

## WHITEHALL COMMUNITY GARDEN PROPOSAL

To: Jackson Community Redevelopment Agency  
101 E Main Street, Jackson, TN 38301

From: Keep My Hood Good  
119 Riverside Drive, Jackson, TN 38301

Purpose: Whitehall Community Garden Proposal

Map: 078F Grp: F Ctrl Map: 078F Parcel: 065.00 (616 Whitehall Street, Jackson, TN 38301)

Parcels: Map: 078F Grp: F Ctrl Map: 078F Parcel: 065.01 (618 Whitehall Street, Jackson, TN 38301)

By: *Juanita Jones*

Date of current submission *March 10<sup>th</sup>, 2021*



## PROJECT PROPOSAL

KEEP MY HOOD GOOD – WHITEHALL COMMUNITY GARDEN | PAGE 1 OF 2

A. Project/Program Summary	
<b>Mission Statement</b>	Keep My Hood Good helps teach the principles of accountability, excellence, integrity and respect of self and to others to under privileged youth in our community.
<b>Overview &amp; Goals</b>	
<b>Funding</b>	This project has already secured funding from a local grant award, granting our project an initial installment of \$5,000. Furthermore, additional funding will be accessed throughout the year through targeted garden fundraising. A detailed budget and planned spending report can be provided by request from Jonathan Bell at <a href="mailto:jonathan.bell@bxs.com">jonathan.bell@bxs.com</a> .
<b>Motivation for Garden</b>	Keep My Hood Good is seeking to transform the health of communities by increasing the availability of fresh and locally grown produce in communities that have long lacked such access. Access to healthy food is a critical prerequisite for health and obesity prevention. By providing convenient access to affordable, healthy, fresh, and culturally appropriate food, a community can promote health for all its residents. Traditional retail outlets (such as grocery stores and restaurants) potentially provide access to healthy food, but communities are increasingly looking to innovative, lower-cost strategies that may be easier to start and more responsive to local needs and preferences. We hope by creating another well-planned community garden directly in a rich and growing community that it would greatly impact the neighborhood.
<b>Site &amp; Physical Planning</b>	Our planning committee will work in conjunction with Celeste Scott, who serves as our Horticulture Extension agent.
<b>Method of Transfer</b>	Donation or Friendly Sale from the Jackson Community Redevelopment Agency to Keep My Hood Good.
<b>Estimated duration of project:</b>	May 2022
<b>Experience:</b>	Keep My Hood Good has maintained a community garden at 701 East Chester since May of 2016. Our garden has been used as an educational and communal space for our community.



## PROJECT PROPOSAL

KEEP MY HOOD GOOD – WHITEHALL COMMUNITY GARDEN | PAGE 2 OF 2

### B. Conclusion

Through this project, we hope to directly contribute to improving food access for residents in East Jackson by distributing fresh produce to the students' families and area neighbors. We will evaluate this outcome by recording the number of individuals/families that produce is distributed during the summer and fall harvests. The students will also develop a community survey to evaluate recipients' overall satisfaction with the project and how this contributed to their food needs. Students will complete this survey with their families and neighbors during the final produce distribution in October. This project will also provide the students of KMHG with greater exposure to more career paths and technical skills, such as site planning, construction, maintenance, art, gardening, and place-making. The students will also learn resource and neighborhood stewardship through this project. We will evaluate these learning outcomes by surveying the students upon project completion in October.

This project will help promote greater unity in our community through involving a number of organizations and volunteers that represent various interest groups and demographic backgrounds in Jackson, with the common goal to improve vitality in East Jackson.

### C. Supporting documents submitted

- Map indicating the location of the project
- Parcel description
- Garden succession plan
- Draft layout

# Madison County - Parcel: 078F F 065.01

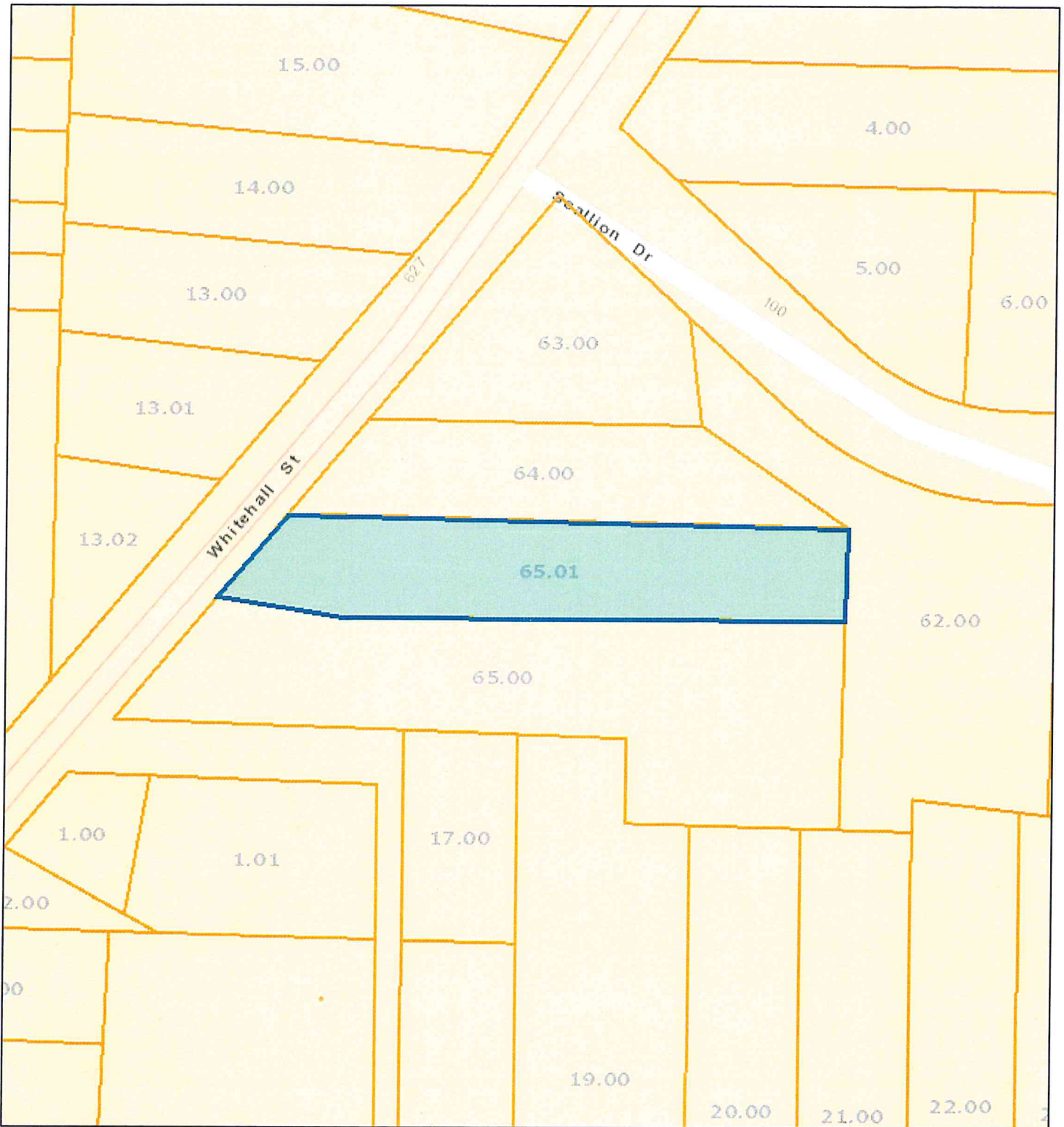

Date: February 19, 2021  
County: Madison  
Owner: DAVIS TERESA  
Address: WHITEHALL ST 618  
Parcel Number: 078F F 065.01  
Deeded Acreage: 0  
Calculated Acreage: 0  
Date of Imagery: 2016

Sources: Esri, HERE, Garmin, USGS, Intermap, INCREMENT P, NRCan, Esri Japan, METI, Esri China (Hong Kong), Esri Korea, Esri (Thailand), NGCC, (c) OpenStreetMap contributors, and the GIS User Community  
TN Comptroller - OLG  
State of Tennessee, Comptroller of the Treasury, Office of Local Government

The property lines are compiled from information maintained by your local county Assessor's

# Madison County - Parcel: 078F F 065.00

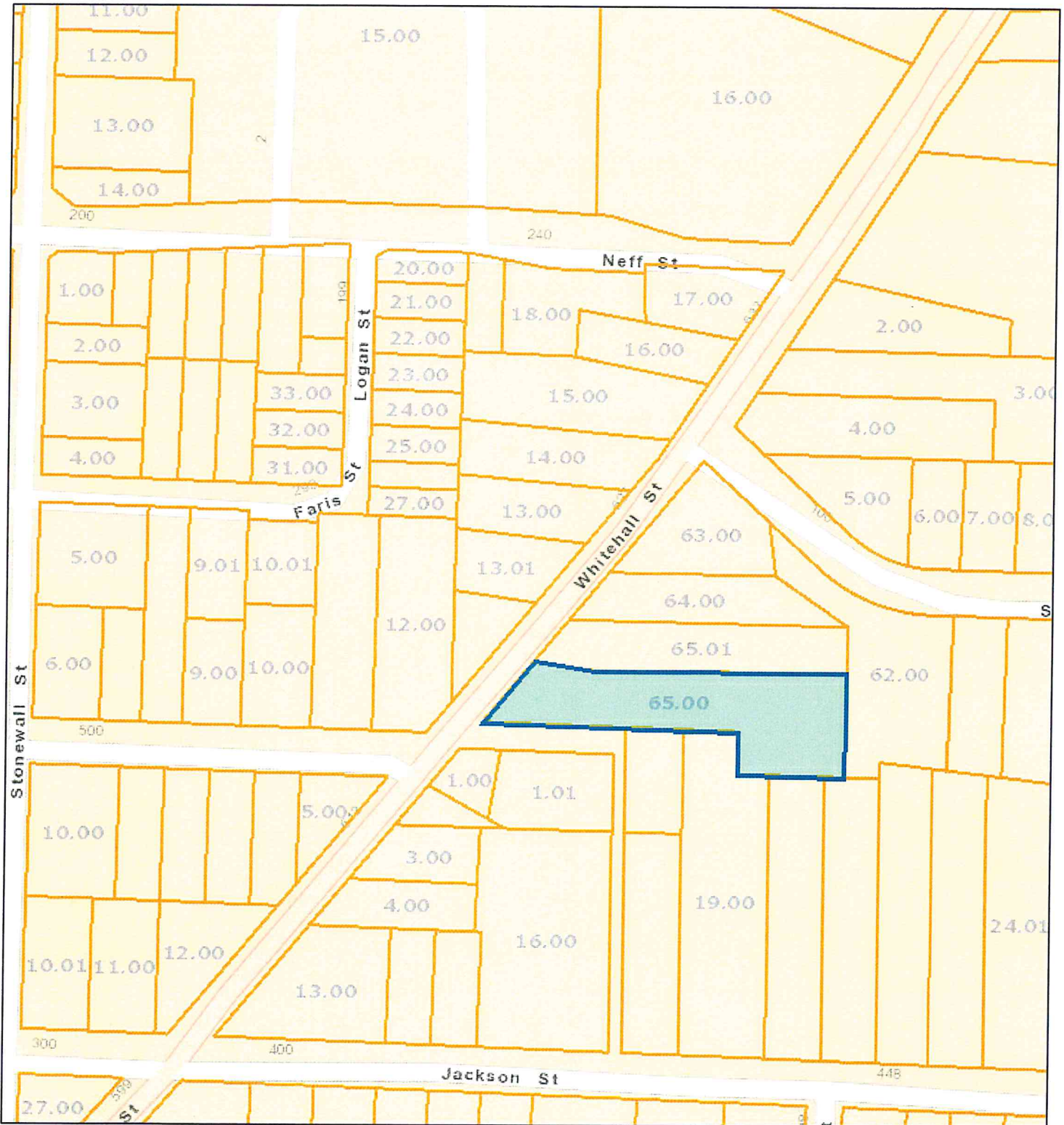

Date: February 19, 2021  
County: Madison  
Owner: DAVIS DUPREE  
Address: WHITEHALL ST 616  
Parcel Number: 078F F 065.00  
Deeded Acreage: 0  
Calculated Acreage: 0  
Date of Imagery: 2016

Sources: Esri, HERE, Garmin, USGS, Intermap, INCREMENT P, NRCan, Esri Japan, METI, Esri China (Hong Kong), Esri Korea, Esri (Thailand), NGCC, (c) OpenStreetMap contributors, and the GIS User Community  
TN Comptroller - OLG  
State of Tennessee, Comptroller of the Treasury, Office of Local Government

The property lines are compiled from information maintained by your local county Assessor's office but are not conclusive evidence of a particular parcel's exact location.

100'

100'

200'

300'

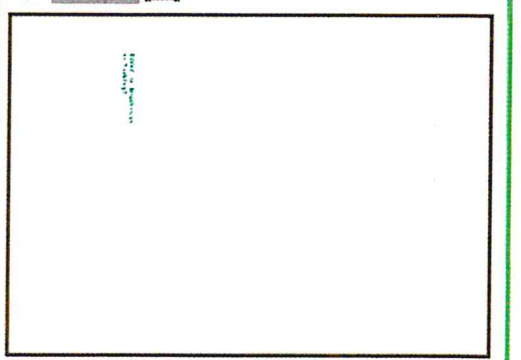
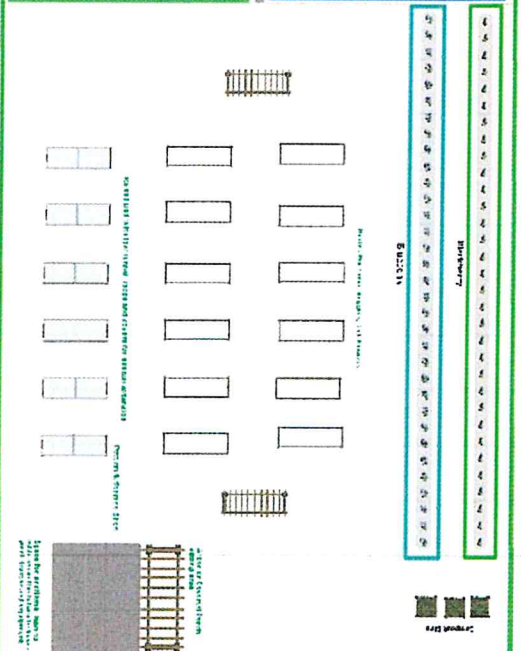
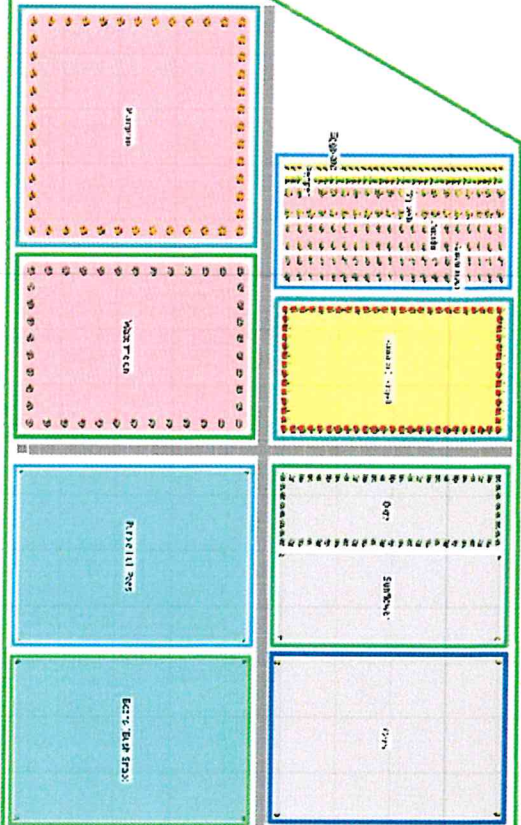

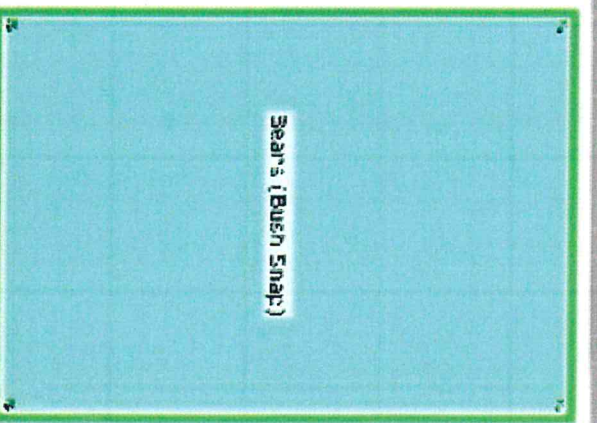
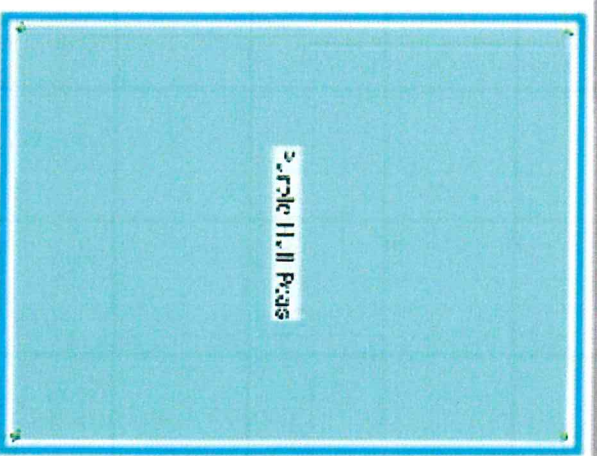
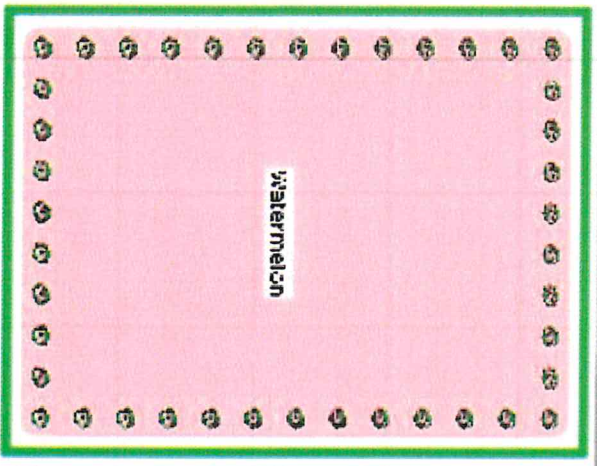
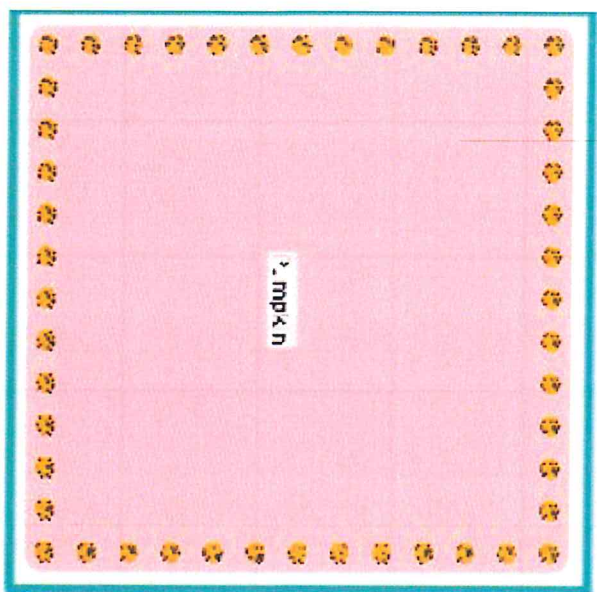
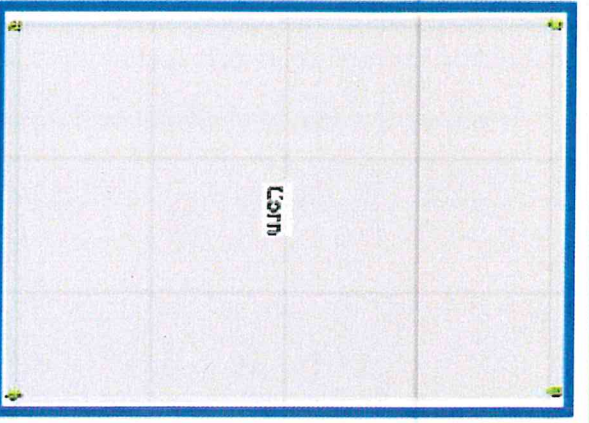
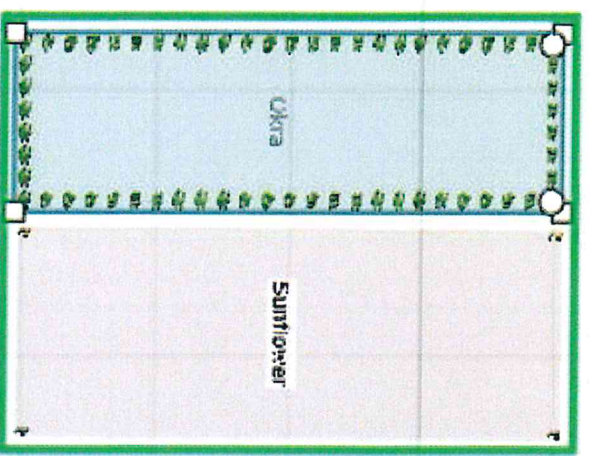
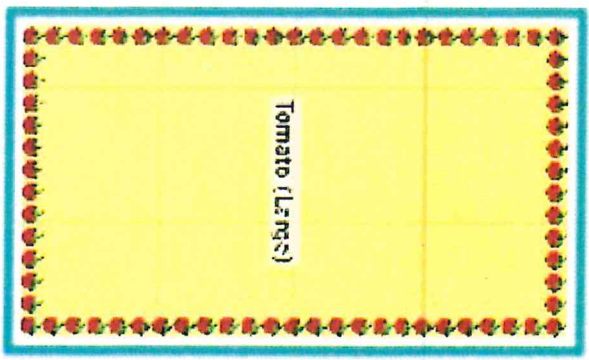
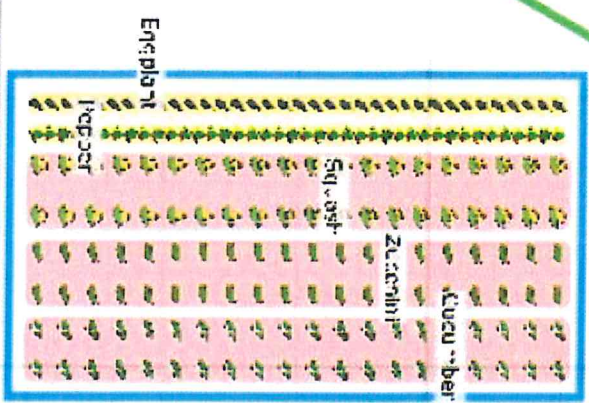

Blackberry

Blackberry



Compost Bins

Buckeye

Feed, Personal Equipment, Car Plowers

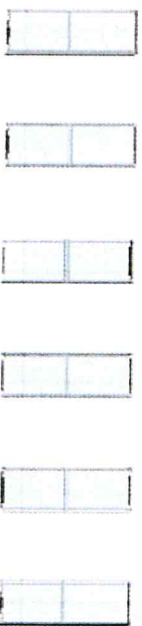
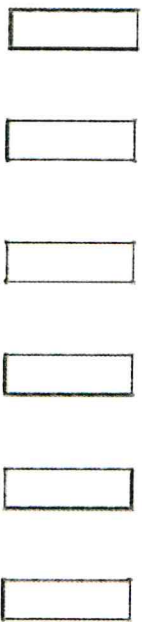
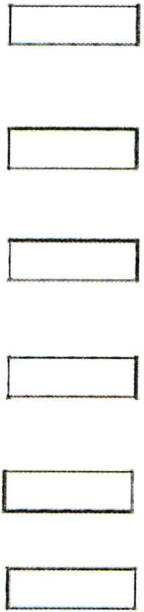

Raised Bed with low tunnel hoops and covers for season extension

Feeding & Storage Shed

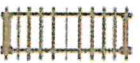
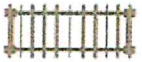

Arbor or Covered Porch sitting area

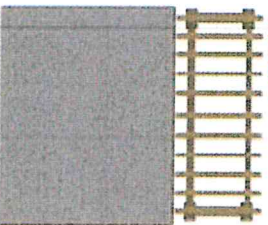

Space for additional lawn in addition to the future to house small tractor and equipment

Room for Expansion or Partings?

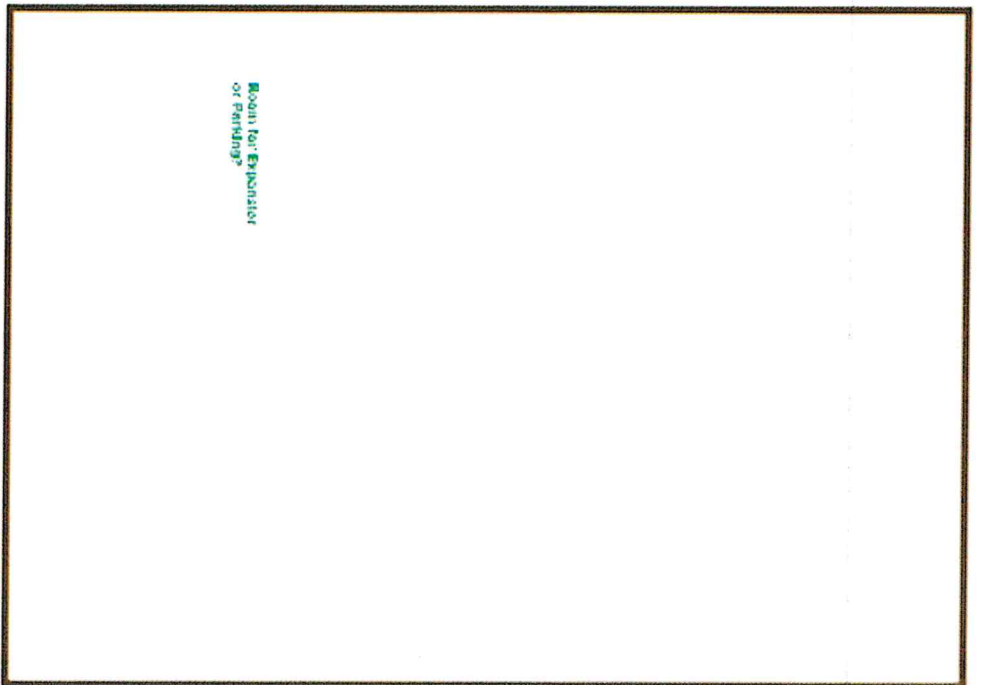



# Keep My Hood Good Garden Plan 2021

## 1<sup>st</sup> Crop

Crop	Variety	Days to harvest	Planting Target	Method	Row Spacing	Plant Spacing	Planting Depth	Harvest Estimate
Sweet Corn	Incredible (yellow)	75 days	May 1	Direct Sow 1 ¼ lb seed	3 ft. (7 rows)	8-12 inch	1 inch	Mid July
Okra	Clemson Spineless & Red Burgundy	60 days 55 days	May 1	Direct Sow 2 oz seed	3 ft. (5 rows)	6 inches Thin to 12 inches	1 inch	Mid July
Pepper Bell	Big Bertha or California Wonder	75 days	May 1	Transplant 40 plants	3 ft. (5 rows)	18-24 inches	Top of root ball	Mid July
Banana	Sweet Banana							

### Resources

**Sweet Corn** <https://extension.tennessee.edu/publications/Documents/D61.pdf>

**Okra** [https://secure.caes.uga.edu/extension/publications/files/pdf/C%20941\\_5.PDF](https://secure.caes.uga.edu/extension/publications/files/pdf/C%20941_5.PDF)

**Pepper** <https://extension.tennessee.edu/publications/Documents/D60.pdf>

## 2<sup>nd</sup> Crop

Crop	Variety	Days to Harvest	Planting Target	Method	Row Spacing	Plant Spacing	Planting Depth	Harvest Estimate
Watermelon n Standard Small	Crimson Sweet Sugar Baby	85 days 76 days	June 1	Direct Sow 60 seeds	5 Horizontal rows	Rotating 4 and 3 plants per row	1 inch 3 seeds per hill	August 5
	Pinkeye Purple Hull	65 days	June 1	Direct Sow 1 lb seed	2 ft. (10 rows-H)	2 inches	1 inch	August 5
Green Beans	Blue Lake 47 (Bush)	58 days	June 1	Direct Sow ½ lb. seed	3 ft. (7 Rows- H)	4 inches	1 inch	August 5

### Resources

**Watermelon** <https://extension.tennessee.edu/publications/Documents/D62.pdf>

**PurpleHull Peas** <https://www.uaex.edu/publications/PDF/FSA-6020.pdf>

**Green Beans** <https://extension.tennessee.edu/publications/Documents/D58.pdf>

### 3<sup>rd</sup> Crop

Crop	Variety	Days to Harvest	Planting Target	Method	Row Spacing	Plant Spacing	Planting Depth	Harvest Estimate
<b>Mustard Greens</b>	Tendergreen	40 days	August 21	Direct Sow Broadcast 2 oz seed	1 ft.	1 ft.	Surface sow	October 5
<b>Turnip Greens</b> Make a turnip No turnip just greens	Purple Top Seven Top	50-60 days 40-45 days	August 14 August 21	Direct Sow Broadcast 1 ½ oz	Broadcast	Broadcast	Surface sow	October 5
<b>Pumpkins</b> Standard Jack Small	Howden Field Trip	100-120 days	June 19-100 June 5- 120	Direct Sow 150 seed	7 Horizontal rows	Rotate 7 & 6 plants per row	1 inch 3 seeds per hill	October 5
<b>Cabbage</b>	Blue Vantage Katarina	75 days	July 24	Transplant 169 plants	3 ft. (13 rows- H)	18 inches (13 plants/row)	Top of root ball	October 5
<b>Collards</b>				Direct Sow Broadcast 1 oz. seed	2 ft.	1 ft.	Surface sow	October

#### Resources

**Greens & Cabbage** <https://extension.tennessee.edu/publications/Documents/D59.pdf>

**Pumpkins** <https://extension.tennessee.edu/publications/Documents/D62.pdf>

## Other UT Home Garden Resources!

W346-A Site Selection <https://extension.tennessee.edu/publications/Documents/W346-A.pdf>

W346-B Garden Planning <https://extension.tennessee.edu/publications/Documents/W346-B.pdf>

W346-C Plant Nutrition <https://extension.tennessee.edu/publications/Documents/W346-C.pdf>

W346-D Plant Management <https://extension.tennessee.edu/publications/Documents/W346-D.pdf>

W346-E Raised Beds <https://extension.tennessee.edu/publications/Documents/W346-E.pdf>

W346-I Harvest & Storage <https://extension.tennessee.edu/publications/Documents/W346-C.pdf>

# May

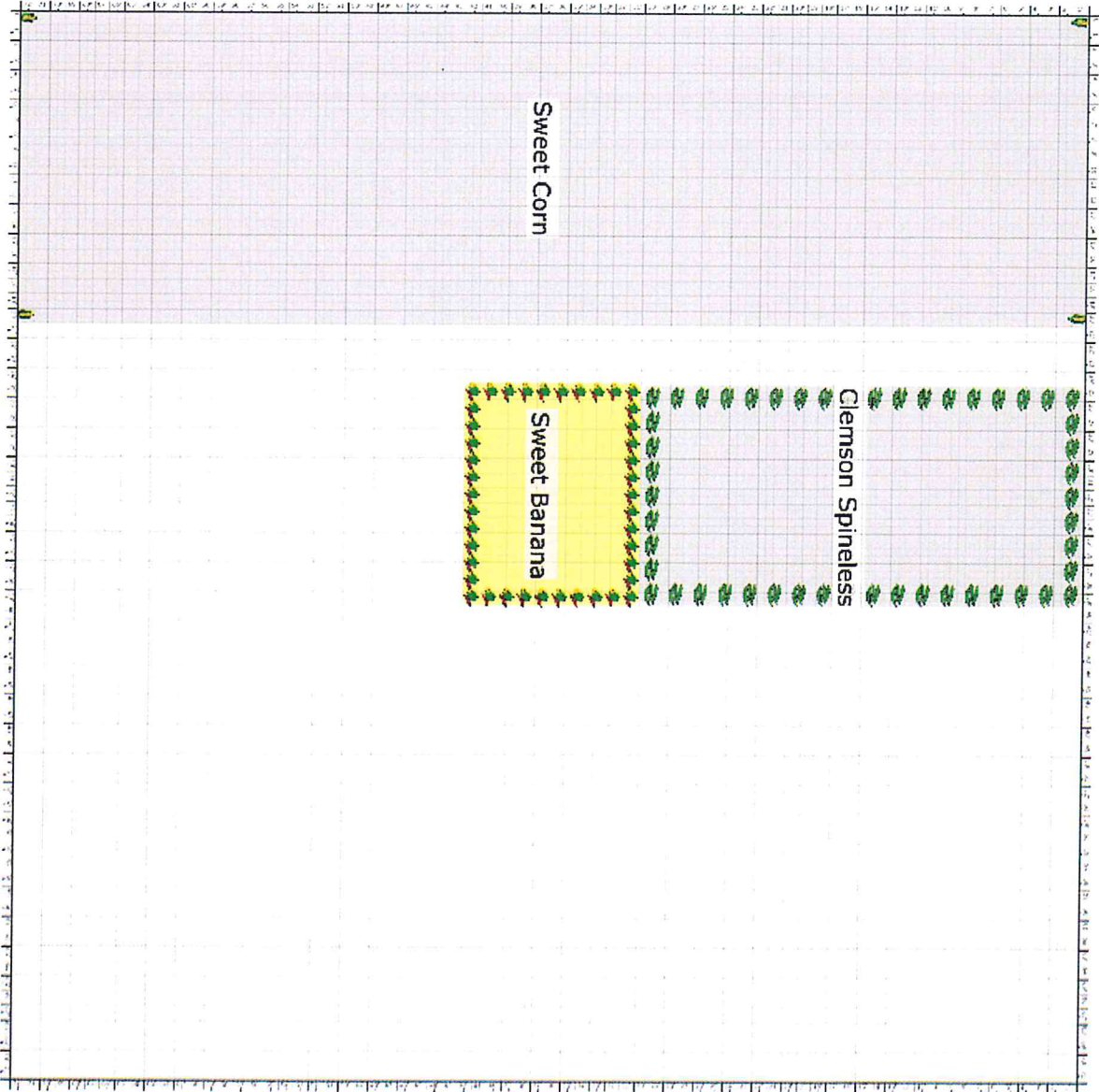

# June

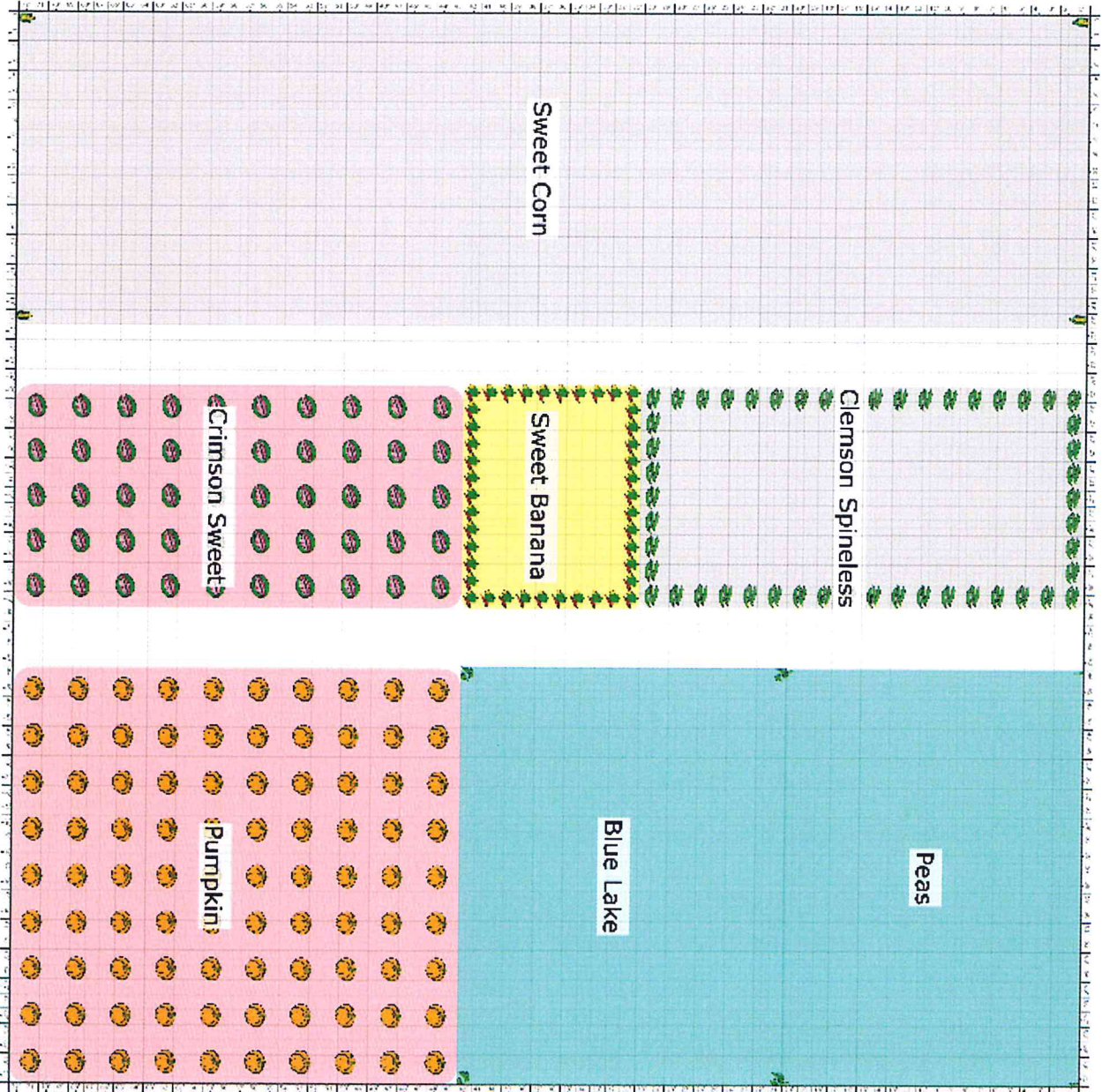

August

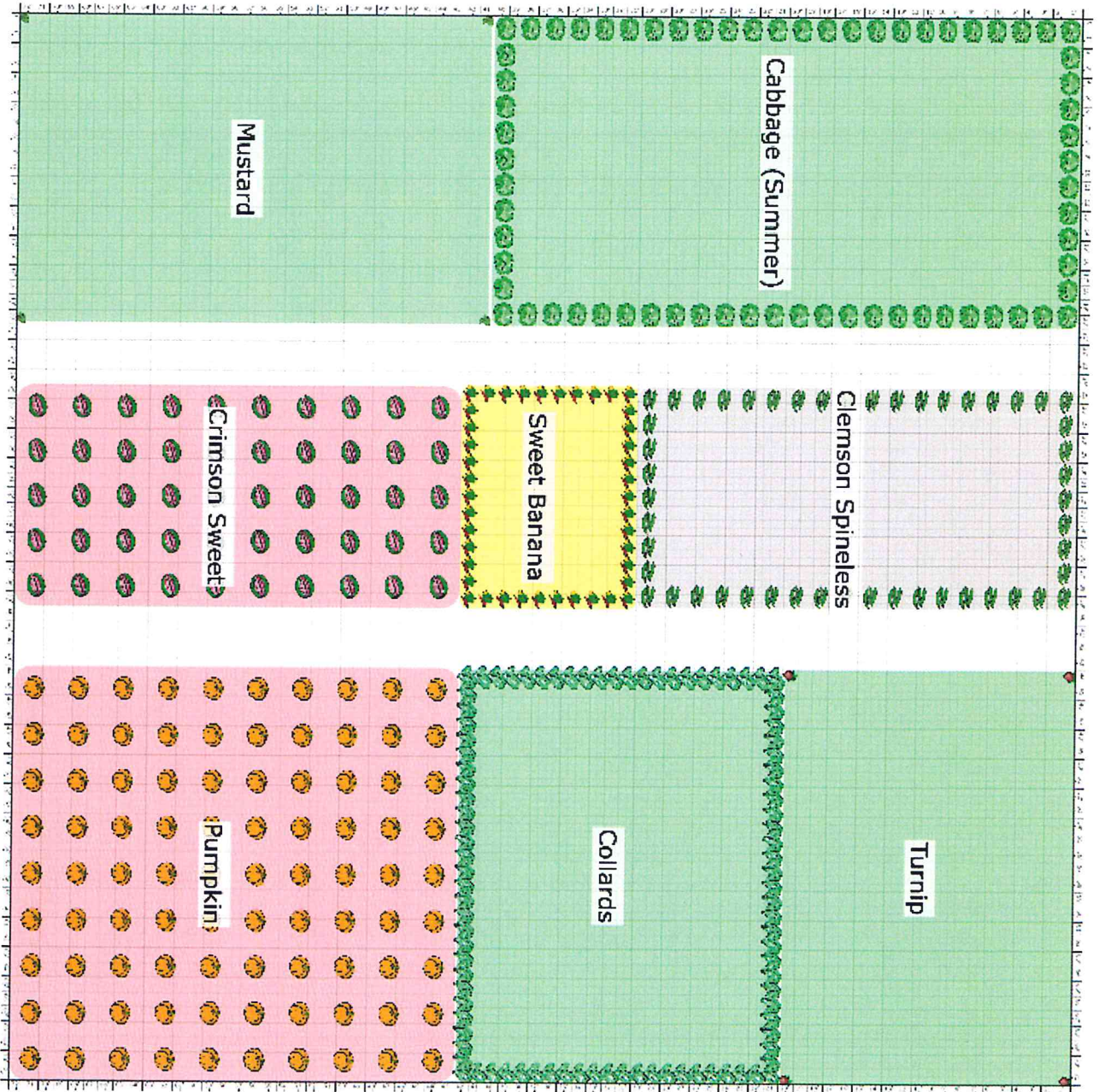

November



